

BIM70

32.88" x 16.75" x 21.25" (H x W x D)

Undercounter auto defrost icemaker for built-in or freestanding use, makes 65 lbs. of clear ice per day

Highlights:

Makes up to 65 lbs. of clear ice in a day cycle

Flexible design allows built-in or freestanding use in 17" wide spaces

Versatile design is ideal for hotels, wet bars, and restaurants

Save time and energy with low maintenance automatic defrost



Slim undercounter dimensions	Less than 17" wide for an easy fit
Built-in capable	Make the best use of space by installing your appliance under the counter
Fully finished stainless steel cabinet	Allows the unit to be used freestanding
Large capacity	Produces up to 65 lbs. of ice in a day cycle, with a 25 lb. storage bin capacity
Clear ice	Gourmet bullet-shaped ice is crystal clear, measures 1 3/8" diameter by 1 1/8" height
Overfill prevention	Unit senses when bin is full and will automatically stop until ice is removed
Sliding door	Top lid is on lift-up glides for easy access to the ice bin
Energy efficient design	WattSipper listed to perform using less energy than federal standards require
Automatic defrost	No-frost system simplifies maintenance
Insulated storage bin	Ice stays frozen longer inside this cold-protected bin

BIM70 Specifications:

Height	32.88"
Width	16.75"
Depth	21.25"
Weight	91.0 lbs.
Canadian Electrical Safety	ULC
US Electrical Safety	UL
Voltage/Frequency	115 V AC/60 Hz
Door Swing	Sliding
Defrost Type	Automatic
Thermostat Type	Dial
Fan Type	Exterior
Low Side PSI	120.0
Freon Oz	6.88
Refrigerant Type	R134a
High Side PSI	320.0
Compressor Warranty	5 Years
Parts/Labor Warranty	1 Year

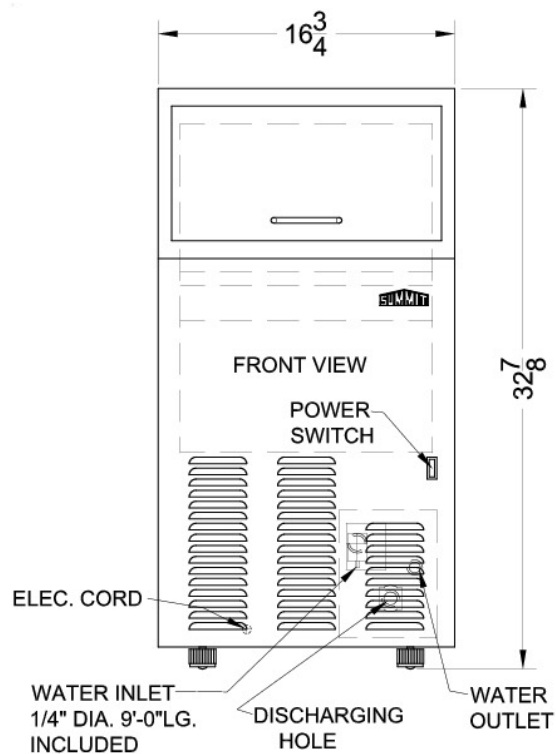
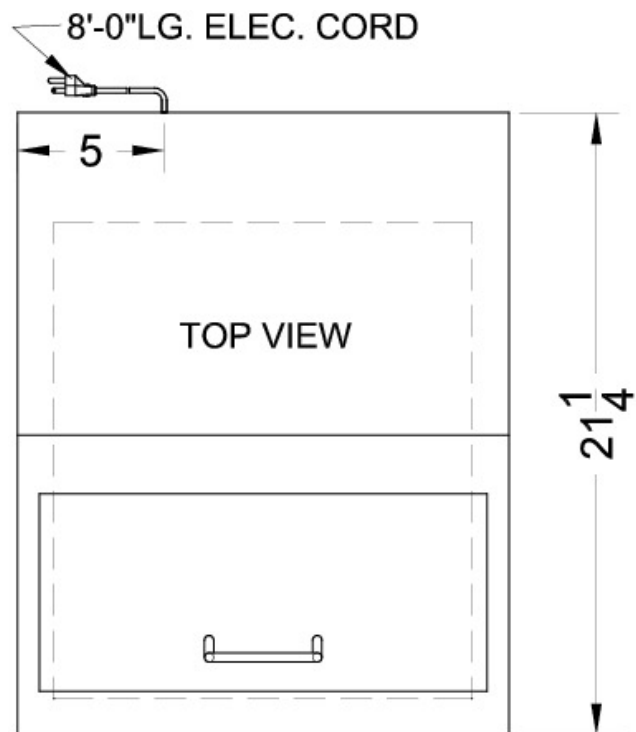

Summit Appliance Division, Felix Storch, Inc.
 770 Garrison Ave • Bronx, NY 10474
 Phone: 718-893-3900 • Fax: 718-842-3093
 Email: info@summitappliance.com